

## MDT Navigated Biopsy Needle

Image Guided Surgery

### Product Benefits

- Inner cannula will not retract or advance when cutting window is open
- Larger gauge cannula for greater stability
- Smooth, stutter free removal of inner cannula which lowers the risk of unintended change of needle position
- Easy and intuitive color-coded indicator window that shows when the side cutting window is open or closed
- Compatible with Stealth Station 7&8, Navigus and Vertek

### Product Specifications

- Cannula Diameter: 2.1 mm
- Cutting Window: 10mm

\*Medtronic® and StealthStation® are registered trademarks of Medtronic, Inc. Medtronic does not endorse nor is affiliated with IZI Medical Products.

Manufactured in the U.S.

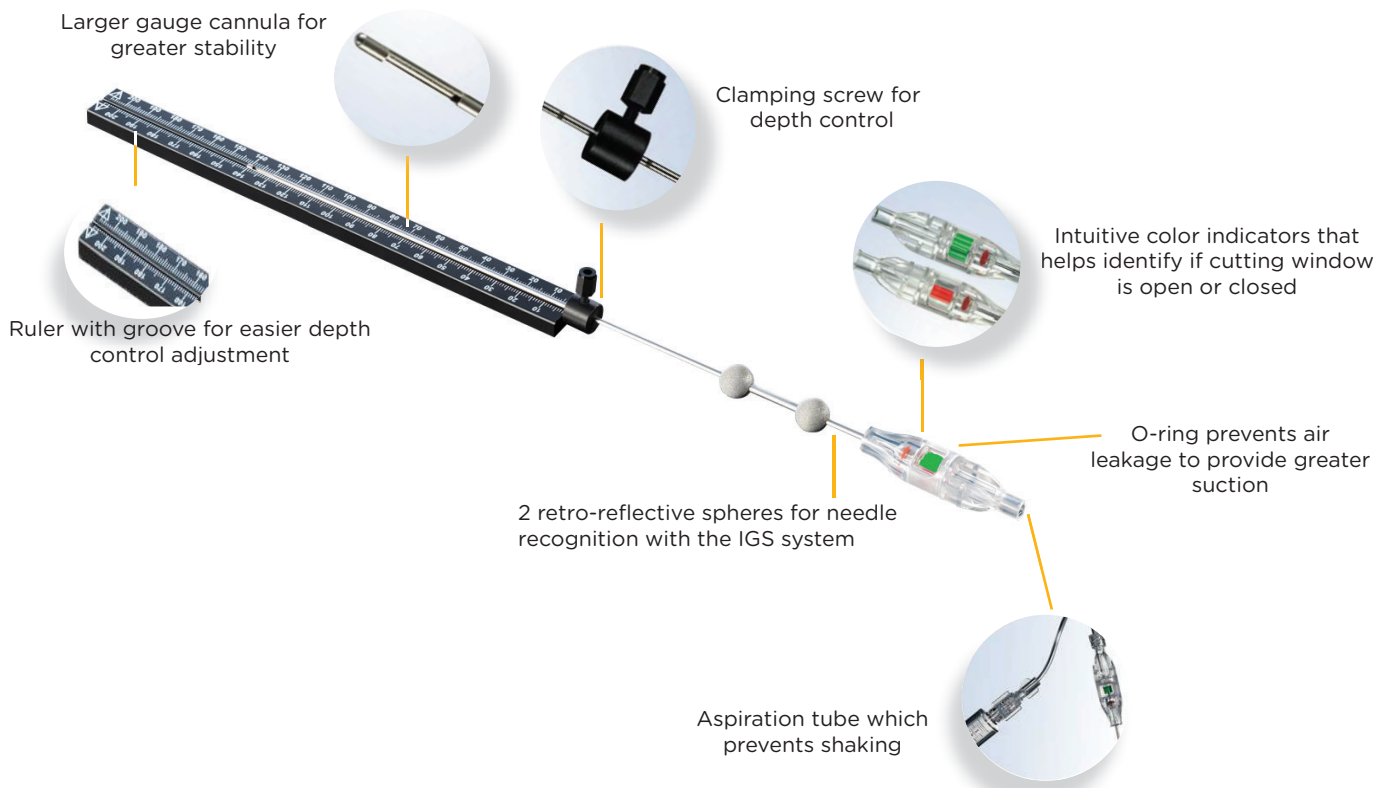

## MDT Navigated Biopsy Needle Ordering

PART NUMBER	DESCRIPTION
MB3000	Navigated Biopsy Needle